

45 x 45 Angle Bracket

Description:

- To connect two aluminium profiles at right angles.
- Suitable for 45 x 45 profile (10mm slot)

Material:

- Die Cast Aluminium

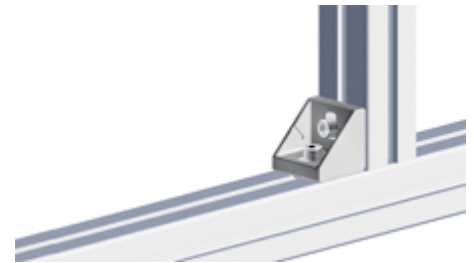
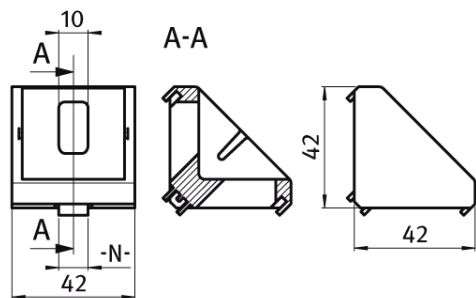

Version	Size	Slot Size	Weight (g)	Part No
Bracket Only	42 x 42 x 42	N = 10	56.0	KJN 523 558
Bracket & Fittings	M8 x 25 (x2)	10		KJN 523 561

