

## 30x30 Corner Bracket

### Description:

- To connect up to three aluminium profiles at right angles.
- Suitable for 30 x 30 profile (8mm slot)

### Material:

- Die Cast Zinc

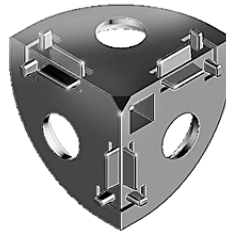
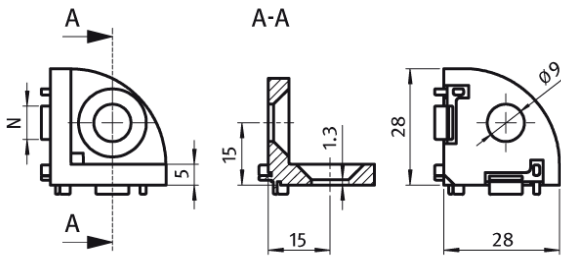

Version	Size	Slot Size	Weight (g)	Part No
Corner Bracket	30x30	N = 8	39.00	KJN 519 319

